

**PERFORMANCE:**

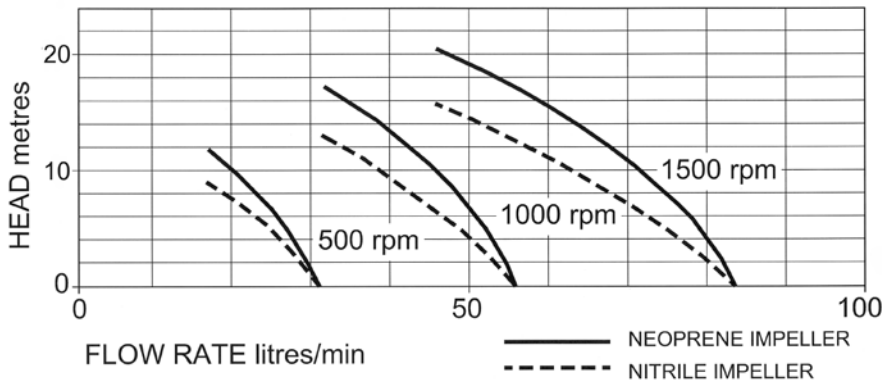

| MODEL           | Maximum flow rate |          | Maximum head |      |
|-----------------|-------------------|----------|--------------|------|
|                 | l/min             | gall/min | metres       | feet |
| <i>9710-200</i> | 82                | 18       | 20           | 65   |
| <i>9710-237</i> | 82                | 18       | 18           | 59   |

Max power absorbed 550 watt at 1500rpm

**DIMENSIONS:**

**WEIGHT: 3.4Kg**

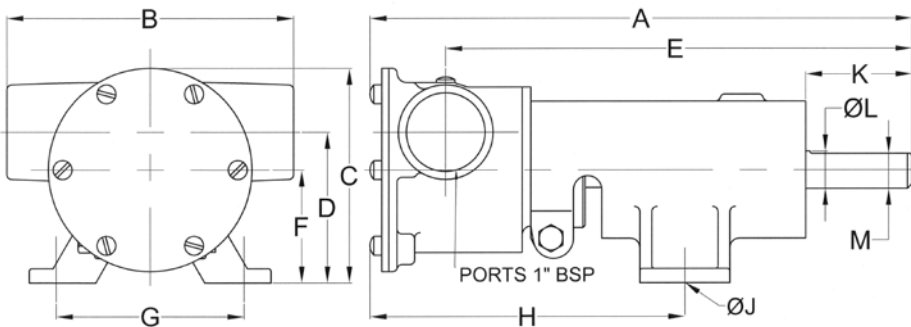

| A   | B   | C  | D  | E   | F  | G  | H   | J   | K  | L     | M    |
|-----|-----|----|----|-----|----|----|-----|-----|----|-------|------|
| 229 | 121 | 91 | 64 | 197 | 48 | 79 | 133 | Ø10 | 45 | Ø15.9 | 14.8 |

**MATERIALS OF CONSTRUCTION:**

|                   |                            |
|-------------------|----------------------------|
| <b>Body</b>       | Bronze                     |
| <b>Impeller</b>   | Neoprene or Nitrile        |
| <b>Wearplate</b>  | Replaceable                |
| <b>Shaft</b>      | Stainless steel type 316   |
| <b>Shaft seal</b> | Mechanical, carbon-ceramic |
| <b>Bearings</b>   | Twin single row, ball type |
| <b>Port type</b>  | 1" BSP to BS21 (DIN2999)   |

**MODELS:**

- 9710-200*    *Standard Neoprene impeller*
- 9710-212*    *Oil resistant Nitrile impeller*
- 9710-237*    *High pressure Neoprene*



a xylem brand  
**BRONZE  
 FLEXIBLE  
 IMPELLER  
 PEDESTAL PUMP**  
**9710** SERIES



**PUMP with  
 1" BSP PORTS**

- \* Constructed from marine quality bronze and stainless steel
- \* Self-prime from dry up to 2.4m
- \* Easy to service and maintain
- \* Will tolerate abrasive wear
- \* Handles hard and soft solids without clogging
- \* Can pump in either direction
- \* Will not airlock



Cleghorn Waring  
 Icknield Way • Letchworth Garden City • Hertfordshire • SG6 1EZ  
 Telephone: +44 (0)1462 480380 Fax: +44 (0) 1462 482422  
 mail@cleghorn.co.uk www.cleghorn.co.uk